

# GENERAL HIGHWAY MAP DEUEL COUNTY NEBRASKA

PREPARED BY THE  
DEPARTMENT OF ROADS  
TRANSPORTATION PLANNING DIVISION  
IN COOPERATION WITH THE  
U.S. DEPARTMENT OF TRANSPORTATION  
FEDERAL HIGHWAY ADMINISTRATION

1984

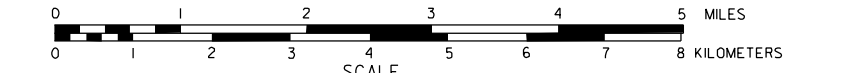

REVISION HISTORY		
NAME	DATE	REVISION
L. GOLDSMITH	OCT, 2000	911 SYSTEM

### LEGEND

- Primitive Road
- Unimproved Road
- Gravel or Crushed Rock
- Asphalt Bituminous Surface
- Concrete/Brick Surface
- Multiple Lane Undivided Highway
- Divided Highway
- Interstate Highway with Full Control of Access
- Side Roads and Streets
- Interstate-Numbered Highway
- US-Numbered Highway
- State-Numbered Highway
- State-Numbered Highway Spur
- State-Numbered Highway Link
- Interstate Exit Number
- Wide Stream
- Narrow Stream
- Irrigation Ditch
- Reservoir, Pond or Lake
- Reservoir, With Dam
- Highway Bridge-Any Type, over 20' span
- Small Bridges-Closely Spaced, pavements, bridge spans within bridges or gravel
- General Bridge-wood, steel, concrete
- Arch Bridge
- Truss Bridge
- Pedestrian Underpass
- Pedestrian Overpass
- Railroad Overpass
- Railroad Underpass
- Railroad
- Dam with Road on Top
- Cattle Guard
- Dwelling
- Row of Dwellings
- Cemetery
- Church or Other Religious Institution
- Church with Cemetery Adjacent
- Hospital
- Business
- Industrial Plant
- Filling Station
- Grain Elevator
- Aggregate Pit
- Agricultural Experimental Station
- Educational Institutions
- Public Use Area
- Recreational Facilities
- Rest Area
- Ranger Station
- Fish Hatchery
- Community Hall
- Correctional Institution
- Tourist Court or Motel
- Monument-Small
- Museum
- Courthouse
- Armory
- Post Office
- Highway Maintenance Yard
- Dump Area
- Sewage Disposal Plant
- Water Supply Stand Pipe
- Pipe Line
- Transmission Line
- Power Plant
- Power Substation
- Radio or TV Station
- Pumping Station
- Weight Station or Part of Entry
- Commercial or Municipal Airport
- Airport with Paved Runways
- State Boundary
- County Boundary
- Township Line
- Section Line
- Corporate Limit Lines
- Parks and Other Reservations
- Boundary Limits of Area Shown in Enlargements to be engineers for future
- State Capital
- County Seat
- Other Cities and Villages
- Incorporated City or Village
- Tranquility Station
- Points Between Which Distances Are Measured Indicated Thus
- Latitude and Longitude
- Nebraska Coordinate System in thousands of feet
- Universal Transverse Mercator Grid in thousands of feet

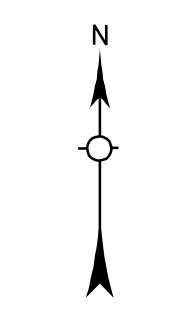
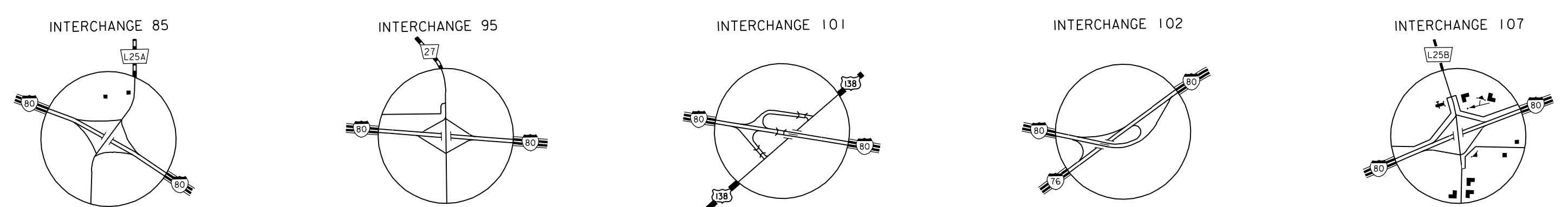
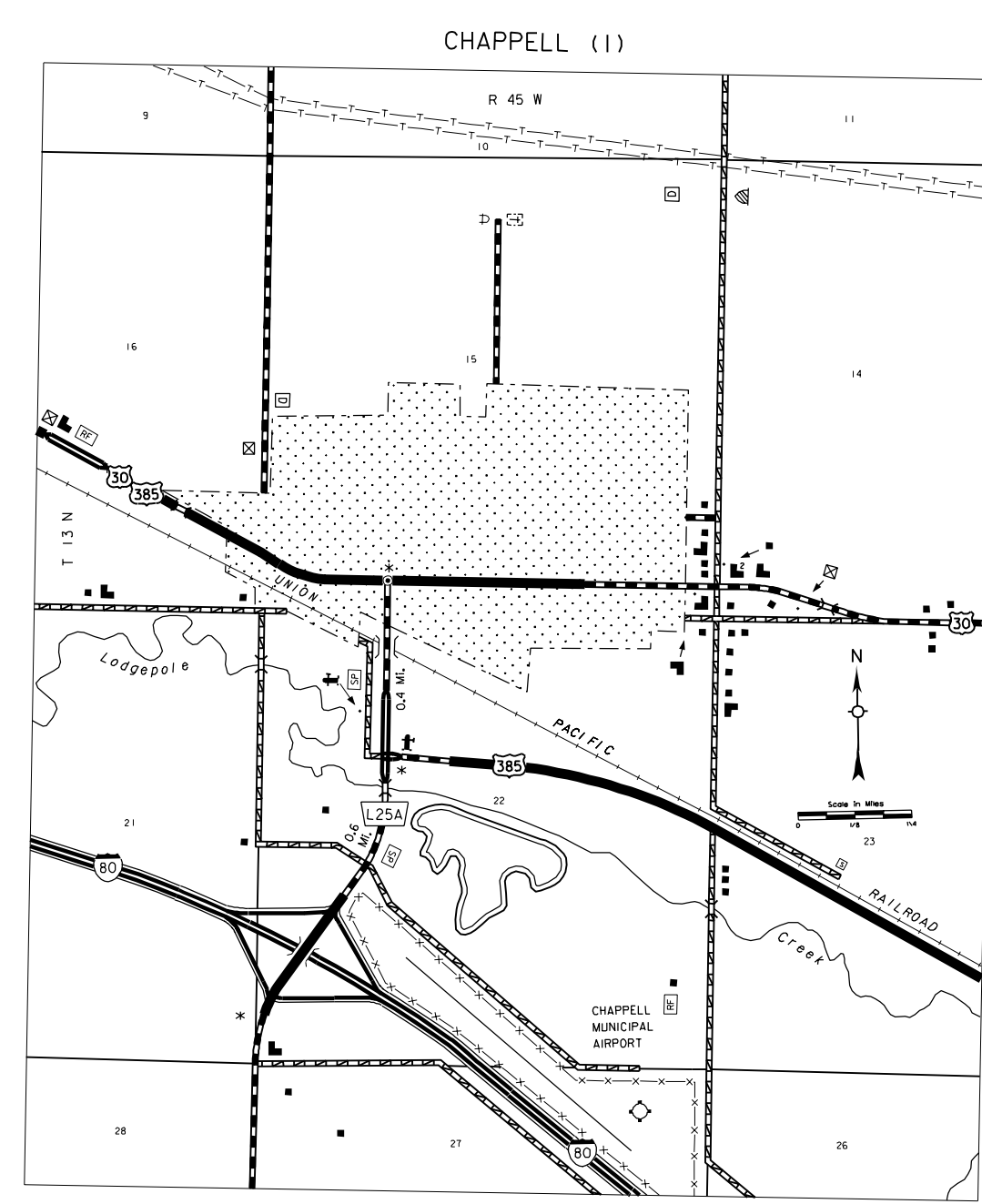
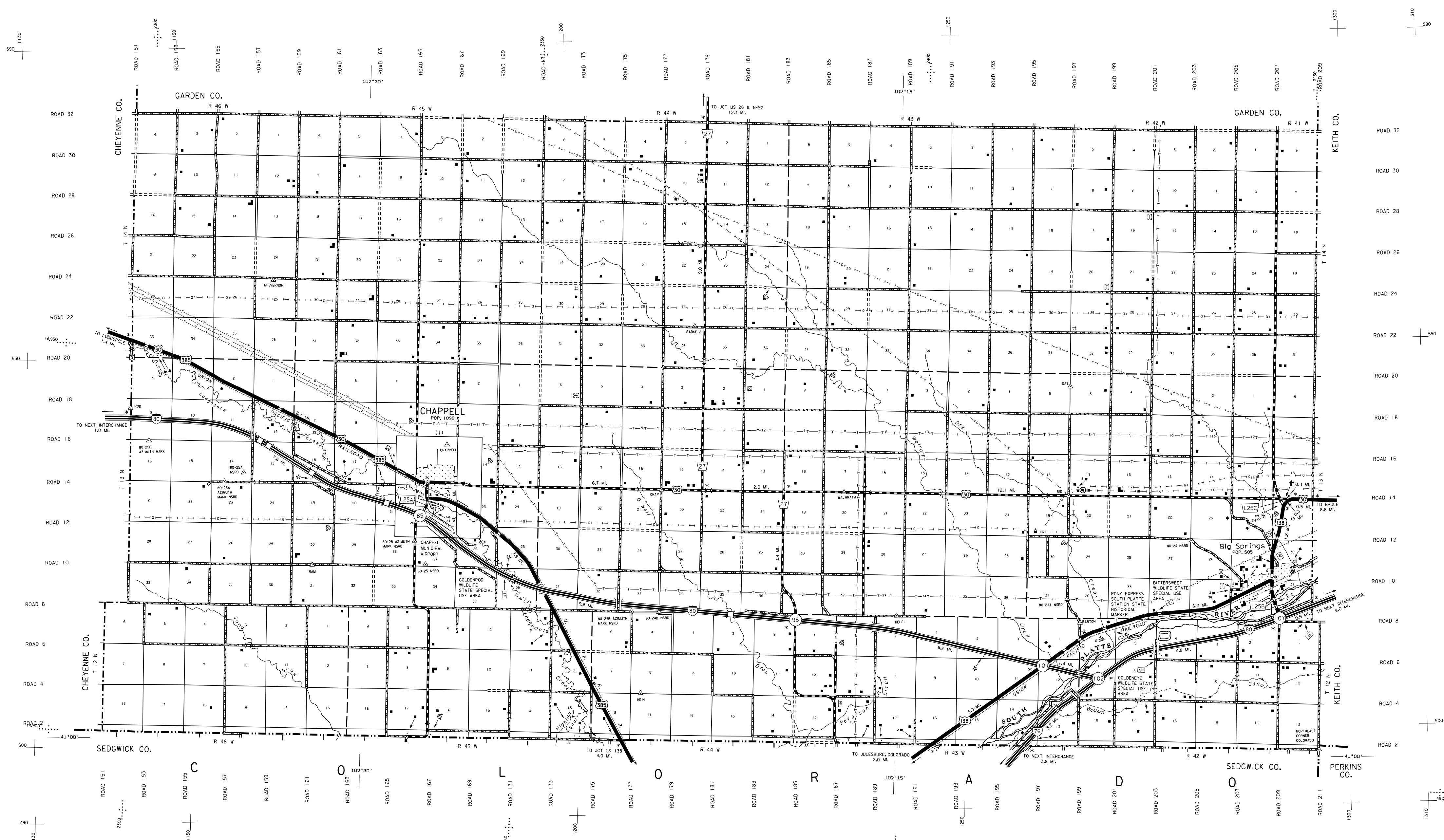

LAMBERT CONFORMAL CONIC PROJECTION  
1927 NORTH AMERICAN DATUM  
NEBRASKA COORDINATE SYSTEM-SOUTH ZONE

