

119-00

120-00

121-00

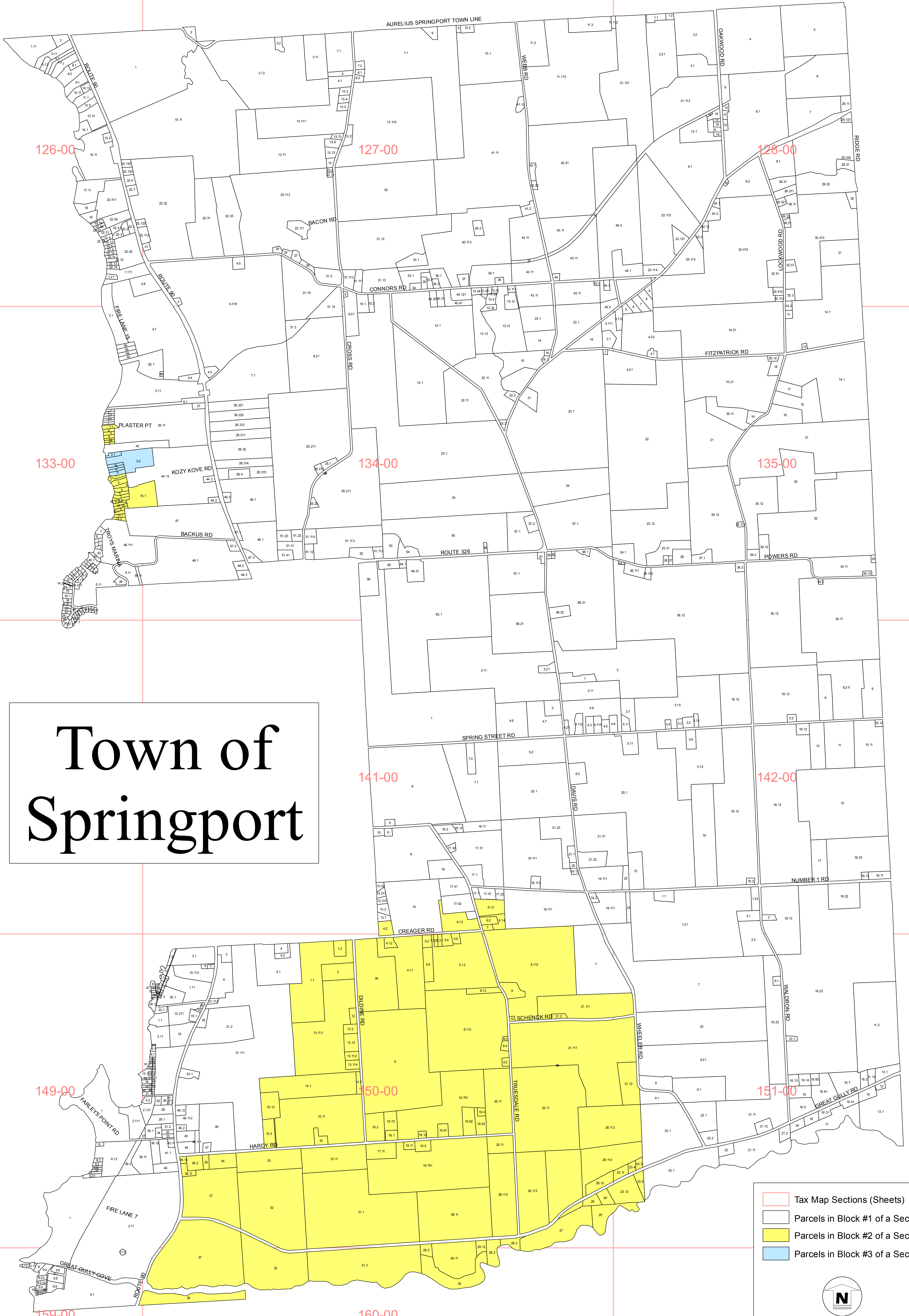

Town of Springport

- Tax Map Sections (Sheets)
- Parcels in Block #1 of a Section
- Parcels in Block #2 of a Section
- Parcels in Block #3 of a Section

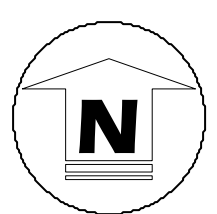

0 300 600 1,200 1,800 2,400 3,000 Feet

Cayuga County Department of Planning and Economic Development
June 2009