

## GREENLAWN CEMETERY – Section 19

This section is located at the far east side of the cemetery. We read the section beginning at the back row, against the fence, going from south to north, and then north to south on the next row. Inscriptions were read by Jackie P. Journey and Joyce M. Sadler, April 2002.

This row begins in about the middle of the section and is located back against the fence by the alley.

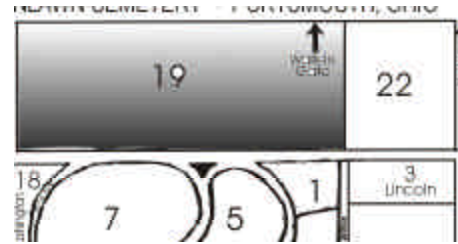

WEAGHTER, Caroline	Dec. 4, 1841 / Aug. 10, 1918
BUSSA, Dortha M.	Aug. 13, 1910 / Mar. 31, 1911 / "Dau. of E.T. & G.H. Bussa"
RICE, William L.	Feb. 6, 1909 / Feb. 23, 1911 / "Son of L. & W. Rice"
HEFNER, Howard	May 14, 1912 / "Son of W. & L. Hefner" / "Our Baby"
KITCHEN, Arnold	Jan. 14, 1913 / Mar. 31, 1913 / "Son of E. & P. Kitchen"
MEADOWS, Albert	Sept. 2, 1806 / Mar. 17, 1913 / Son of C.B. & M. E."
WILLIAMS, Homer C.	Oct. 17, 1912 / Feb. 20, 1913 / "Son of J.N. & S.W."
MAYBERRY, Bobby George	Sept. 13, 1931 / July 11, 1999 / "PFC US Army Korea"
MCGUIRE, Ellis	1893 – 1913
CARTER, Sallie	May 17, 1902 / Dec. 10, 1918 / "At Rest"
MUNYON, Edith	Jan. 3, 1895 / Jan. 28, 1919 / "Wife of Earl Munyon"
SEXTON, Mary F.*	May 15, 1892 / Dec. 2, 1912 / "Wife of C. Sexton" /
SEXTON, Dorlene Elizabeth*	Aug. 20, 1912 / Nov. 4, 1912 / "Dau. of C. & M.S. Sexton"
KEYES, Fred Blackburn	Aug. 28, 1911 / Dec. 13, 1911 / "Son of F.R. & E.O. Keyes"
<hr style="border-top: 1px dashed black;"/>	
KOEGELE, Katherine	1835 – 1927
KOEGELE, Daniel L.	1891 – 1906
MINCH, Caroline	July 2, 1870 / Apr. 26, 1910
SHELA, Sophia	1852 – 1937 / "Wife of Jacob Shela"
SHELA, Jacob	1843 – 1925 / "Co B 56 <sup>th</sup> Regt OVI"
KERR, Lon S.	Nov. 16, 1856 / Feb. 6, 1934
KERR, Clara B.*	1881 - 1948
KERR, Chester A.*	1880 - 1973
OAKLEY, Elsie May Kerr	1902 - 1984
KIMBLE, Elsie Heid	June 18, 1894 / Dec. 22, 1924
HEID, Mary M.*	Sept. 3, 1853 / Jan. 1, 1924
HEID, William*	Jan. 2, 1850 / Sept. 22, 1929
FINGER, Irene L.*	1899 - 1951 / "Daughter"
FINGER, Bertha A.*	1878 - 1963 / "Mother"

## GREENLAWN CEMETERY – Section 19

NOEL, William F.	1873 - 1954
NOEL, Maggie	1874 - 1942
CIESLER, Anna Marie	1824 - 1903
JONES, Louverna	Sept. 2, 1908/ March 27, 1910/ "Daughter of S.M. & M.V. Jones"
WALKER, Nettie	Sept. 10, 1907/ March 28, 1910
CARVER, Lula	Dec. 28, 1916/ Aug. 17, 1917/ "Daughter of L.T. & B. Carver"/ "Gone Home"
RUANE, Martin	1855 - 1933
RUANE, Henrietta Stahl	1859 - 1926
PARKER, George C.	Dec. 25, 1848 / Apr. 7, 1902 / "Co H 7 Regt Ohio Cav"
<hr/>	
GILLYARD, Lillie V.*	1907 - 1988/ "At Peace with God"
GILLYARD, Hayes H. Rev.*	Aug. 2, 1888/ Oct. 16, 1982/ "PFC US Army WWI"
ROSS, William E. Jr.	1857 - 1938/ "At Rest"
FERGUSON, Orville R. III "Britt"	June 26, 1967/ Jan. 12, 1992/ "Forever Loved"
PARKER, Margaret	1894 - 1976
PARKER, Carl F.	1890 - 1954
FERGUSON, James Eddy	March 23, 1927/ Nov. 18, 1967/ "OH A1C 801 Food Service Sq AF Korea"
BULLARD, Ople Ferguson	Oct. 23, 1924/ May 31, 2000/ "Rest In Peace"
JAMISON, Troy	Aug. 8, 1890/ Feb. 1, 1933/ "OH Pvt Co H 372 Inf WWI"
SANDERS, James	Aug. 27, 1889/ Dec. 21, 1932/ "Alabama Pvt Co B 437 Labor BN OMC WWI"
CAVE, Claudia L.	1909 - 1932
BRAWLEY, Charles	Feb. 5, 1888/ Aug. 17, 1932/ "Oh PFC Co B 511 Svc BN Engr Corps WWI"
GABBIN, Willie	May 25, 1932 - / "OH Pvt 155 Depot Brig"
TAYLOR, Anna	June 15, 1817/ May 2, 1904
HOLT, Mary A.	"Wife of Albert Holt" - Stone has sunk in the ground.
PARKER, Annie E.	1846 - 1911/ "Mother"
PARKER, George C.	Dec. 25, 1843/ April 7, 1902/ "Father"/ "Co. H. 7th Regt. OH Cav"
WARD, Jennie	Sept. 22, 1862/ Oct. 23, 1930
NICHOLS, Henrietta B.*	1900 - 1989
NICHOLS, Dudley C.*	1900 - 1941/ "In Loving Memory"
WEAVER, Emma Jackson	June 18, 1850/ Jan. 26, 1902
COLEMAN, Hattie B.	Feb. 26, 1876/ Nov. 17, 1900

## GREENLAWN CEMETERY – Section 19

SLOAN, W. J.*	1846 -
SLOAN, Jennie*	1844 - 1900/ "His Wife"
STAHL, Louise	1853 - 1926
MILSTEAD, Anderson	Jan. 25, 1909/ Apr. 1, 1910
GEARHART, Ethel	Oct. 11, 1907/ Apr. 2, 1910/ "Our Darling"
CLARK, Mary Beyer	1850 - 1929
BEYER, Wm F.	1873 - 1923
NEAL, Anna B.*	1895 - 1918
NEAL, Susan M.*	1917 - 1918
HEID, Mary	nd
CAMPBELL, Viola	1889 - 1917
METZGER, Elizabeth	1858 - 1933
METZGER, Maria	1833 - 1903/ "Mother"
METZGER, Jacob	1822 - 1906/ "Father"
SHELA, William D.	Jan. 19, 1913/ Nov. 13, 1913
DAUB, Mary E.	1875 - 1944
DAUB, Christian	1842 - 1944/ "Father"
DAUB, Elizabeth	1842 - 1921/ "Mother"
HEID, Paul L.	1918 - 1919/ "Son of A. & E. Heid"/ "At Rest"
_____, Gertrude	1903 - 1904
YOUNG, Madeline	1907 - 1930
YOUNG, Emma L.*	1872 - 1954
YOUNG, Charles P.*	1877 - 1950
MCCOY, Jas. H.	nd
MCCOY, Jane Ann	nd
MCCOY, Frank	1868 - 1942
BARD, Wm	1846 - 1919/ "Co. B 220 VI"
BARD, Martha J.	Oct. 2, 1848/ Oct. 6, 1925
RODGERS, Lydia C.	Sept. 20, 1885/ Mar. 18, 1923
JUSTICE, Anna V.	1910 - 1912
-----	
DAVIS, Richard C.	June 23, 1911/ Feb. 9, 1912/ "Son of A.C & A. Davis"
SALSBURY, Infant Twins	Feb. 14, 1912/ "Infant Twins of J. & Z. Salsbury"
WOLFF, Edith E.	1914 - 1979
CLINE, Henry L.*	1850 - 1920
CLINE, Emma R.*	1849 - 1942/ "His           Wife"

## GREENLAWN CEMETERY – Section 19

PEED, A. Cline	Dec. 7, 1883/ Sept. 13, 1958
PEED, Elise Cline	May 4, 1876/ Oct. 3, 1969/ "In Loving Memory"
GIBSON, Goldie M.	1910 - 1911
CLARK, Orpha A.	April 3, 1911/ Aug. 15, 1911/ "Daughter of D.L. & B.M. Clark"
POTTER, Henry	1838 - 1924
POTTER, Phebe	1840 - 1923
PERRY, Emily*	1862 - 1931
RICHARDS, Lucy*	1885 - 1932
RUTHERFORD, Charles W.	Mar. 13, 1909/ Aug. 29, 1918
BARBEE, Charles L.	1887 - 1902
SPONSLER, Emmabelle	1908 - 1909
WORKMAN, Elnora M.	Stone is sunk in the ground - dates unreadable
SNYDER, William P.	1900 – 1917
GAGE, Caroline	1856 – 1911
GAGE, William	1853 – 1929
CHANDLER, Alpha W.	1855 - 1941
CAREY, Kittie Chandler	1876 - 1959
WASHINGTON, William	1894 - 1939/ "In Memory Of"
QUEST, Ruby Y.	1896 - 1937
CHAVOUS, Levi	Mar. 30, 1883/ Dec. 12, 1936
WILSON, Elizabeth	1845 - 1933/ "Mother
MARSHALL, Jessie	Mar. 30, 1879/ June 18, 1933
BERRY, Anna Belle	1904 - 1934
WHITAKER, Hattie	1902 - 1931
TYLER, Nettie Alice	1870 - 1934
GARDNER, Maddie M.	1872 - 1935
SAUNDERS, Eunice*	1902 -
SAUNDERS, Russell H.*	1899 - 1971/ "Thy Will Be Done"
<hr style="border-top: 1px dashed black;"/>	
LAYNE, Louella*	1908 - 1995/ "Married Oct. 10, 1929"
LAYNE, John R.*	1907 – 1985
BULLARD, Gilbert F.	Aug. 24, 1895/ Aug. 29, 1936/ "Oh Pvt 813 Pioneer Inf."

## GREENLAWN CEMETERY – Section 19

DENNIS, James Edward	1870 – 1935
MEADE, Goldie J.	1897 - 1979
SCHLICHTER, George J.	1925 - 1940
KAH, Jennie S.	1879 - 1960/ “Mother Kah”
KAH, John Edward Sr.	1872 - 1942/ “Father Kah”
MCGEE, Chloe E.	Oct. 30, 1866/ Sept. 29, 1973
CORNWELL, John*	1844 -1906
CORNWELL, Annie*	1843 -1915
KESSLER, Leopold*	Feb. 12, 1831/ Dec. 31, 1899
KESSLER, Elizabeth*	Nov. 10, 1844/ Mar. 17, 1921/ “His Wife”
JENKINS, Abraham	Jan. 13, 1861/ Nov. 21, 1917/ “Aged 56y/ “In Loving Memory of My Dear Husband”
DAVIS, Evelyn M.	Nov. 28, 1909/ Aug. 23, 1910/ “Daughter of A.C. & R.A. Davis”
WISE, Mary	b. Dec. 17, 1908/ d. Aug. 17, 1910
HOUCHINS, Mayme E.*	1884 - 1968
HOUCHINS, John T.*	1877 - 1956
GREGORY, Clara	July 10, 1859/ Dec. 7, 1943
KING, George L.	Jan. 11, 1913/ Sept. 25, 1913
FERRELL, James*	1850 - 1923
FERRELL, Mary C.*	1832 - 1908/ “His Wife”
THOMAS, Thomas	1852 - 1917
LUTHER, Eliza	1837 - 1906
DRESSLER, Mary Potter	1873 - 1927
HANSGEN, Joseph A.	Jan. 5, 1867/ July 23, 1918/ “Woodsmen of the World Memorial”
POTTER, Emma Louise	1878 - 1961
TOWNSEND, Lessie	1883 - 1976
YOST, Daniel W.	1851 - 1930
HARTZ, Becky*	1893 - 1986
HARTZ, Warren J.*	1890 - 1979/ “Together Forever”
YOST, Robert M.	1895 - 1955
YOST, Inez	1895 - 1977
ZIEGLER, John J.	Dec. 15, 1917/ Dec. 21, 1917/ “Son of G.C. & S.A. Ziegler”
ALLEN, Fair	1910 - 1912/ “Son of B.F. & S. Allen”
SMALLEY, Thelma R.	July 15, 1907/ Sept. 26, 1911/ “Daughter of J.A. & B. Smalley”
MATHIOT, Rosa Giesler	Nov. 12, 1855/ Oct. 5, 1941

## GREENLAWN CEMETERY – Section 19

VETTER, Caroline	May 23, 1837/ Aug. 15, 1905
FREUND, George W.*	1876 - 1937
FREUND, Edith Z.*	1876 - 1973
WOLFF, Elizabeth*	Jan. 17, 1913/ Sept. 11, 1993
WOLFF, Edith E.*	Apr. 15, 1914/ July 4, 1979
WOLFF, Anna K.*	1875 - 1938
WOLFF, John H.*	1866 - 1947
BROOKER, Emma H.	1889 - 1976/ "Mother"
LAYHER, Mary	1847 - 1919
WOODRUM, C. Jaunita	Mar. 9, 1912/ Mar. 11, 1912/ "Daughter of G. & C. Woodrum"
<hr/>	
WORKMAN, Drew W.	Nov. 19, 1911/ May 5, 1912/ "Son of A.J. & L.M. Workman"
WILSON, John	Aug. 8, 1935/ Oct. 25, 1909/ "Oh Vol"
EDWARDS, Sarah J.	1844 - 1934
EDWARDS, William D.	1842 - 1920
ROE, Henry Mefford Jr.*	Mar. 28, 1928/ May 9, 1964/ "Oh Pfc US Army Korea"
ROE, Helen*	1930 -
ROE, Brian David	Nov. 4, 1957/ Oct. 17, 1965
HOTZ, John	1872 - 1959
HOTZ, Ann T.	1880 - 1971
STRATTON, Oakley Lee	Aug. 22, 1910/ Oct. 10, 1911/ "Son of J.P. & N.E. Stratton"/ "At rest"
RICHER, Fred*	b. July 27, 1834/ d. July 27, 1903
RICHER, Annie M.*	d. Mar. 13, 1890 - / "Aged 78y"
SHULTZ, Katherine E.	Apr. 25, 1915/ Oct. 3, 1916
SHULTZ, Roger A.T.	Feb. 2, 1917 / Oct. 2, 1918
WOODLEY, Francis*	b. May 10, 1833/ d. Mar. 1, 1901/ "Wife of H.?" / <i>Inscription</i> : "Children of C.J. and E. M. Woodley"
WOODLEY, Ellen*	May 10, 1883/ Apr. 24, 1885
WOODLEY, John W.*	July 29, 1871/ Dec. 14, 1875
WOODLEY, Henry*	May 10, 1870/ May 17, 1870
CRICHER, Fanny	1869 - 1953
LUNSFORD, Mary A.	Feb. 20, 1893 / Nov. 19, 1919 / "Wife of O.R. Lunsford"
ALBRECHT, Genivie V.	b. & d. Dec. 14, 1910 / "Dau. of C.C. & A. Albrecht"
FARMER, Holland C.	Jan. 12, 1895 / Nov. 26, 1917
BLOOMFIELD, Betty Luce	1923 - 1945
MADER, Theodore F.*	1872 - 1947
MADER, Anna M.*	1873 - 1944 / "His Wife"

## GREENLAWN CEMETERY – Section 19

CORNWELL, John*	1844 – 1906
CORNWELL, Annie*	1843 – 1915
WASHINGTON, Frank	Mar. 15, 1846 / Dec. 17, 1907
GRAY, Jacob	1885 - 1936
LISATH, Selma L. Bush	1912 – 1981 / “Daughter”
SPAULDING, George	Sept. 25, 1936 / “Ohio Cook 317 Engrs 92 <sup>nd</sup> Div”
BULLARD, Gilbert F.	1895 – 1936 / “At Rest”
HAYES, Curley	Aug. 10, 1936 / “Ohio Corp. S13 Pioneer Inf”
MCCLAIN, Leatha	1900 – 1936
GOLDEN, Richard A.	Jan. 19, 1932 -
-----	
LEWIS, Louise H.*	1908 – 1977
LEWIS, John L.*	1896 – 1981
RICHARDSON, Kenneth E.	1936 – 1938
DEERING, Mattie*	1870 – 1905
DEERING, Infant*	1905 / “Infant Son”
CRENSHAW, Charles G.*	May 11, 1877/ Mar. __, 1907
CRENSHAW, Maggie*	July 20, 1874/ May 1, 1875
LAYNE, Wallace Ruben	1932 – 1968
HAIRSTON, Gary Michael Jr.	Nov. 7, 1977 / Dec. 15, 1997
KIELMAN, Anna	1824 – 1905
KELLISON, Katharine Campbell	1897 – 1943
CLIFFORD, Jack Henry	Dec. 29, 1924 / Sept. 24, 1948 / “Ohio AF USNR WWII”
CLIFFORD, Maude	Mar. 10, 1893 / Feb. 25, 1959 / “Mother”
CLIFFORD, Henry C.	Jan. 28, 1889 / June 4, 1934 / “Father” / “At Rest”
CLIFFORD, William M.	Dec. 31, 1861 / Feb. 28, 1931 / “At Rest”
CLIFFORD, Jennie	May 8, 1867 / Jan. 8, 1924 / “Mother” / “At Rest”
CLIFFORD, Sadie	Jan. 30, 1895 / June 3, 1922
CLIFFORD, Edward P.	Apr. 22, 1930 / “Ohio Pvt 158 Depot Brigade”
UPP, Percy Franklin	June 24, 1877 / July 1, 1927
UPP, Jennie M.	1856 – 1926
UPP, Oscar F.	Feb. 22, 1857 / Dec. 17, 1936
UPP, Anna C. Bratt	1870 – 1935
DEAN, Paul R.	Dec. 15, 1910 / Feb. 6, 1911 / “Son of T & N Dean”
MILLER, Arba*	1843 - 1892
MILLER, Alice*	1841 - 1928? / “His Wife”
MILLER, Christine*	1868 - 1894
MILLER, Anna*	1876 - 1876

## GREENLAWN CEMETERY – Section 19

WOODLEY, Francis*	b. May 10, 1833 / d. Mar. 1, 1901 / “Wife of Charles J. Woodley”
WOODLEY, Ellen J.*	May 10, 1888 / Apr. 24, 1885 / “Children of C.J. & S.M. Woodley”
WOODLEY, John W.*	July 29, 1871 / Dec. 14, 1875 / “Children of C.J. & S.M. Woodley”
WOODLEY, Henry M.*	May 10, 1870 / May 17, 1870 / “Children of C.J. & S.M. Woodley”
REDEPENNING, Caroline*	1874 - 1961
REDEPENNING, John*	1869 - 1939
REDEPENNING, John C.*	1828 - 1902
REDEPENNING, Charlotte*	1835 - 1912 / “His Wife and Children”
WISE, <u>Margella</u> F.	b. & d. Oct. 22, 1911 / “Daughter of J.W. & D.F. Wise”
GUINN, Howard A.	1911 – 1911
-----	
BOOK-VANHORN, Grace	May 30, 1893 / Feb. 19, 1921
BOOK, Malinda B.	Aug. 10, 1857 / nd
BOOK, John R.	Apr. 12, 1852 / Dec. 5, 1928
WILHELM, John Day	1837 – 1912
WILHELM, Cora E.	1847 – 1923
ATKINSON, Sophia*	1889 – 1976
ATKINSON, John W.*	1888 – 1969
DEUSCHLE, George C.*	1875 – 1944
DEUSCHLE, Lucy D.*	1878 – 1962 / “Brother and Sister”
DEUSCHLE, S. Albert*	1869 – 1870
DEUSCHLE, F. Charles	1880 – 1883
RODENMEYER, Bessie	1884 – 1961
DEUSCHLE, Mary Freund*	1847 – 1933
DEUSCHLE, L. Fredrich*	1839 – 1906
SICKLES, Donovan	Nov. 25, 1909 / Nov. 6, 1911 / “At Rest”
EAVES, Lydia V.	1865 – 1908
EAVES, George	1826 – 1908
STEARNS, Frederick A.	May 20, 1845 / June 25, 1906 / “Mus Co G 141 Regt Ohio Inf”
SHULTZ, Alva T.*	1892 – 1963
SHULTZ, Elizabeth*	1896 – 1986
DAVIS, Dewey M.	1899 – 1915 / “50 <sup>th</sup> Co CAC”
MATTHEWS, Elijah	1830 – 1913
FOEHR, Elsie J.	1859 – 1905
HINES, Delbert	1910 – 1911
SCHULER, Charles Theador	1872 – 1956
SCHULER, Sue Molster	1871 – 1943
SCHULER, Johanna	Feb. 23, 1836 / June 12, 1913 / “Mother”
SCHULER, Leonhardt	Apr. 23, 1827 / June 16, 1909 / “Father”
SCHULER, William F.	May 29, 1860 / Jan. 28, 1909

## GREENLAWN CEMETERY – Section 19

CORNUTE, Anna*	1877 – 1946 / “Mother”
WILLIAMS, Genevieve*	1898 – 1958 / “Daughter”
JEFFRIES, Carlene V.	1918 – 1989 / “In Loving Memory”
FIELDS, Martha	b. Oct. 15, 1838 / d. June 27, 1908 / “Mother”
NICHOLS, Charles A.	May 7, 1880 / Jan. 26, 1908
BLACK, Jackson*	d. Apr. 18, 1907
BLACK, Amanda J.*	d. Mar. 20, 1916 / “His Wife”
BUSH, Grace G.	1892 – 1980 / “Mother”
JACKSON, John H.	1867 – 1936 / “At Rest”
DILL, Lewellyn Sanford*	Feb. 19, 1895/ Feb. 17, 1905
DILL, Celcstine Louise*	Sept. 5, 1900/ Aug. 1, 1908
FERGUSON, Sadie*	1874 – 1964
FERGUSON, Albert H.*	1874 – 1950

---

End of Section 19